

# TUCSON<sup>®</sup>

## Fluid Dynamics

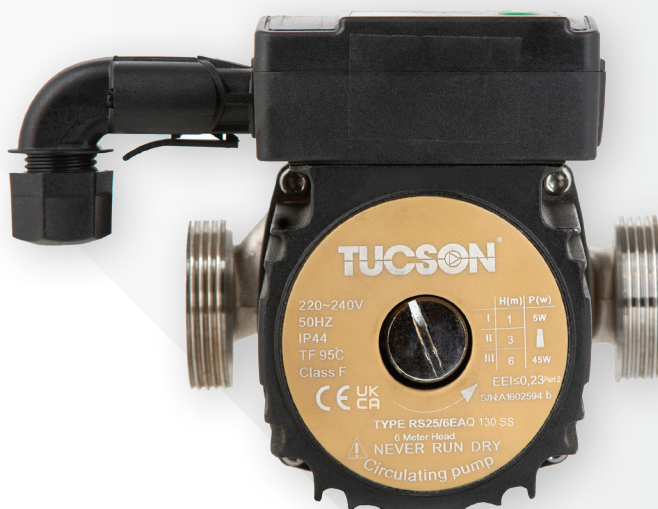

Circulation Pumps

Boiler Pumps

Booster Pumps

Pressure Switches

Pump Accessories

Product Catalogue

# Tucson Cast Iron Volute Circulation Pumps



**ErP**  
COMPLIANT

## Features

- User-friendly control panel
- Suitable for domestic & light commercial applications
- Robust construction
- Compact size
- Easy installation
- 3 years manufacturers warranty

## Technical Data

- EEL (Energy Efficiency Index)  $\leq 0.23$  Part 2
- Voltage: Single Phase, 230 volts  $\pm 10\%$
- Frequency: 50 Hz
- 5M & 6M Speed: 1 to 3 + Auto
- 8M Speed: 1 to 6 + Auto
- Insulation: Class F
- Operating Environment Temperature: 5°C to 40°C
- Minimum and Maximum Fluid Temperatures: 5°C to 95°C
- Max Working Pressure: 10 Bar
- Min Working Pressure: 0.05 Bar @ 50°C
- Waterproof Rating: IP44
- Flange threaded connection dimension - 1 1/2" BSP/G 11/2
- 5 & 6M Pump Weight: 2.35Kg
- Volute / Manifold Material: Cast Iron
- Volute coating material - Electrophoresis
- 8M Pump Weight: 3.6Kg

## Accessories Included

- 5M & 6M - Terminal Plug and Rubber Gaskets
- 8M - Terminal Plug and Rubber Gaskets

| CODE   | PRODUCT      | PALLET QTY | PRICE € |
|--------|--------------|------------|---------|
| 771903 | 5 Metre Head | 256        |         |
| 771904 | 6 Metre Head | 256        |         |
| 771902 | 8 Metre Head | 144        |         |

## 8 Metre Pump Dimensions

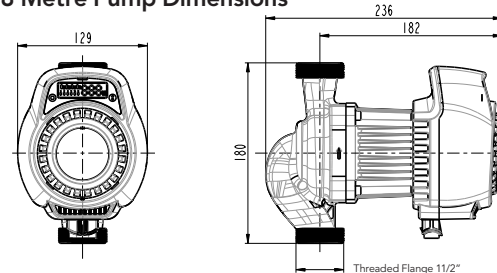

## 5 Metre & 6 Metre Pump Dimensions

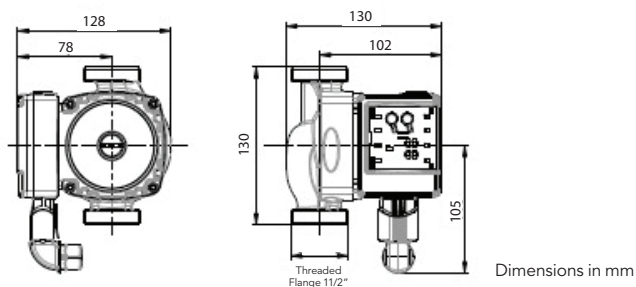

General notes - ErP (ecological design) directive  
The benchmark for the most efficient circulators is EEL  $\leq 0.20$  Part 2

# Tucson Bronze Volute Circulation Pump



**ErP**  
COMPLIANT

## Features

- User-friendly control panel
- Suitable for domestic & light commercial applications
- Robust construction with corrosion resistant materials
- Compact size
- Easy installation
- 3 years manufacturers warranty

## Technical Data

- EEL (Energy Efficiency Index)  $\leq 0.23$  Part 2
- Voltage: Single Phase, 230 volts  $\pm 10\%$
- Frequency: 50 Hz
- Speed: 1 to 3 + Auto
- Insulation: Class H
- Operating Environment Temperature: 5°C to 40°C
- Minimum and Maximum Fluid Temperatures: 5°C to 110°C
- Max Working Pressure: 10 Bar
- Min Working Pressure: 0.05 Bar @ 50°C
- Waterproof Rating: IP42
- Flange threaded connection dimension - 1 1/2" BSP/G 11/2
- Volute / Manifold Material: Bronze
- Volute coating material - Electrophoresis
- Pump Weight: 2.5Kg

## Accessories Included

- Terminal Plug and Rubber Gaskets

| CODE   | PRODUCT      | PALLET QTY | PRICE € |
|--------|--------------|------------|---------|
| 771917 | 6 Metre Head | 256        |         |

## 6 Metre Bronze Body Pump Dimensions

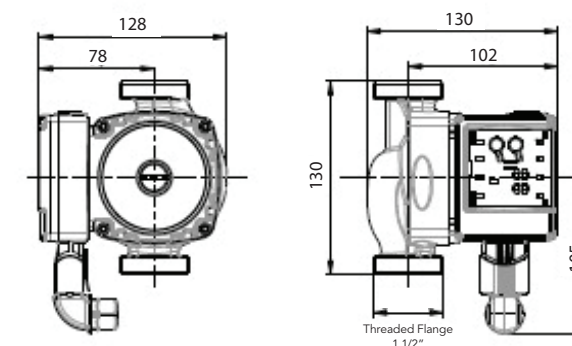

Dimensions in mm



# Tucson Stainless Steel Volute Circulation Pumps



**ErP**  
COMPLIANT

## Features

- Volute dimension available in 130mm & 180mm
- User-friendly control panel
- Suitable for domestic and light commercial applications
- Robust construction
- Made from corrosion resistant 304 Grade Stainless Steel
- Compact size
- Easy installation
- 3 years manufacturers warranty

## Technical Data

- EEI (Energy Efficiency Index)  $\leq 0.23$  Part 2
- Voltage: Single Phase, 230 volts  $\pm 10\%$
- Frequency: 50 Hz
- 1 to 3 + Auto Speed
- Insulation: Class F
- Operating Environment Temperature: 5°C to 40°C
- Minimum and Maximum Fluid Temperatures: 5°C to 95°C
- Max Working Pressure: 10 Bar
- Min Working Pressure: 0.05 Bar @ 50°C
- Waterproof Rating: IP44
- Flange threaded connection dimension - 1 1/2" BSP/G 11/2
- Volute / Manifold Material: 304 grade Stainless Steel
- Volute coating material - Electrophoresis.
- Pump Weight: 2.35Kg

## Accessories Included

- Terminal Plug and Rubber Gaskets

| CODE   | PRODUCT            | PALLET QTY | PRICE € |
|--------|--------------------|------------|---------|
| 771912 | 6 Metre Head 130mm | 144        |         |
| 771913 | 6 Metre Head 180mm | 144        |         |

## 6 Metre 130mm Pump Dimensions

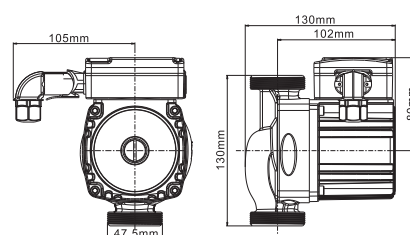

## 6 Metre 180mm Pump Dimensions

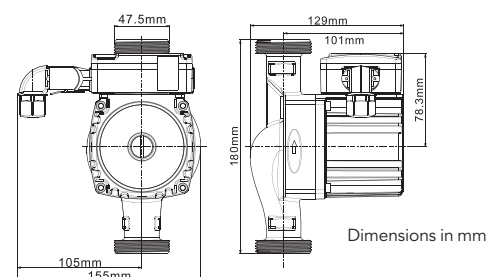

General notes - ErP (ecological design) directive  
The benchmark for the most efficient circulators is EEI  $\leq 0.20$  Part 2

# Tucson OB Circulation Pumps with PWM Control



**ErP**  
COMPLIANT

## Features

- Available in both 6 & 8 Metre Head
- Domestic & light commercial applications
- Robust construction
- Compact design dimensions
- Reduced weight design
- Easy installation
- 3 years manufacturers warranty
- Plug & play cabling
- Pulse Width Modulation (PWM) terminal
- Boiler retro-fit friendly
- TF value of 110°C

## Technical Data

- EEI (Energy Efficiency Index)  $\leq 0.23$  Part 2
- Voltage: Single Phase, 230 volts
- Frequency: 50 Hz
- Insulation: Class F
- Operating Environment Temperature: 0°C to 40°C
- Minimum and Maximum Fluid Temperatures: 2°C to 110°C
- Max Working Pressure: 10 Bar
- Min Working Pressure: 0.05 Bar @ 75°C
- Waterproof Rating: IP44
- Motor Housing material YL102
- Flange threaded connection dimension - 1 1/2" BSP/G 11/2
- Volute / Manifold Material: Cast Iron
- Volute coating material - Electrophoresis.
- Pump Weight: 1.6Kg

| CODE   | PRODUCT                          | PALLET QTY | PRICE € |
|--------|----------------------------------|------------|---------|
| 771946 | 6 Metre Head                     | 256        |         |
| 771947 | 8 Metre Head                     | 256        |         |
| 771948 | PWM Adaptor Wilo™ Compatible     |            |         |
| 771949 | PWM Adaptor Grundfos® Compatible |            |         |

## Tucson 6 & 8 Metre Head OB Circulating Pump with PWM Control

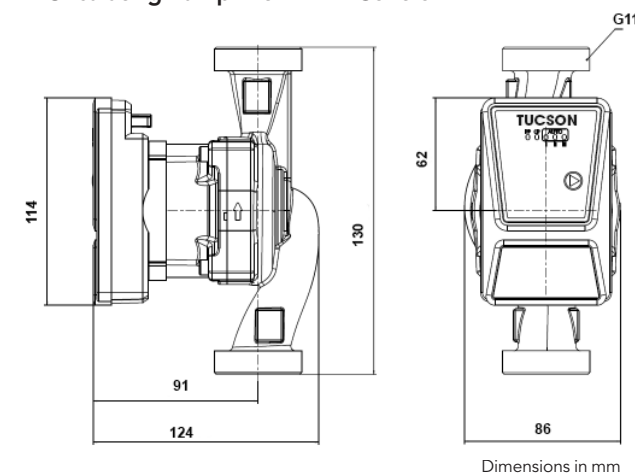

## Accessories Included

- AC power cable (stripped end) x1
- AC power cable adapter (Grundfos® Compatible Connection) x1
- AC power cable adapter (Wilo™ Compatible Connection) x1
- Rubber Gaskets

# Tucson GBPHR Boiler Pump Head Replacement with PWM Control



## Features

- High performance modulating pump
- Optional pulse width modulation (PWM)
- Simple & easy retro-fit in most boiler brands
- Easy set up to maximise boiler efficiency
- 1 year manufacturers warranty
- ErP Compliant

## Technical Data

- EEI (Energy Efficiency Index)  $\leq 0.23$  Part 3
- Pump head pressure range from 4-8M
- Flow rate range up to 31.6 L/min
- Pumped liquid temperature range +2°C - 110°C
- Operating environment temperature 0°C - 40°C
- Relative ambient humidity: 95%
- Voltage / Frequency: 230V, 50/60Hz
- Maximum system pressure: 10 Bar
- Ingress protection: IP44
- Decibel rating: 43 dB
- Insulation class: F
- Pump weight: 1.1Kg

## Product Includes:

- Tucson GBPHR/8/ Pump x1
- Replacement Flange O Rings x2
- Volute assembly Studs x4
- AC power cable (stripped end) x1
- IP Rated terminal block x1
- Quick-fit AC power cable adaptor x1

| CODE   | PRODUCT                             | PALLET QTY | PRICE € |
|--------|-------------------------------------|------------|---------|
| 771928 | GBPHR/8/CW                          | 512        |         |
| 771929 | GBPHR/8/CCW                         | 512        |         |
| 771948 | PWM Adaptor<br>Wilo™ Compatible     |            |         |
| 771949 | PWM Adaptor<br>Grundfos® Compatible |            |         |

GBPHR/8/CW Pump Dimensions

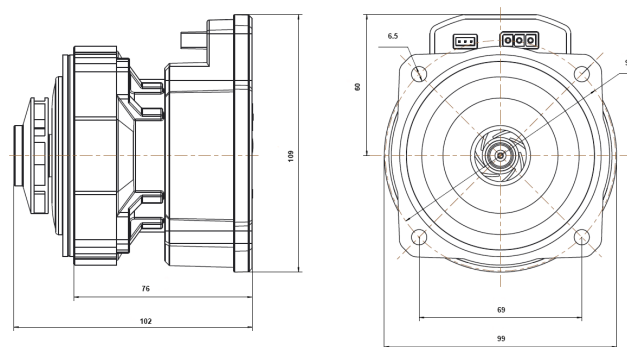

GBPHR/8/CCW Pump Dimensions

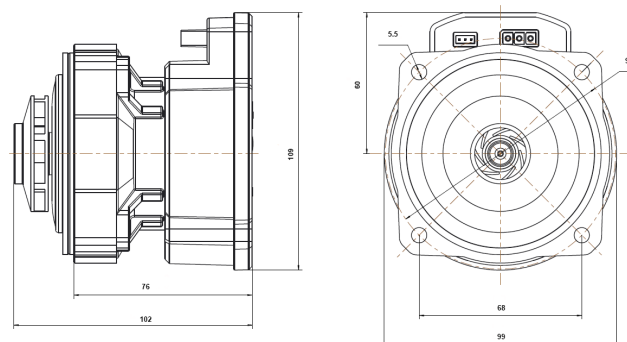

# Tucson MBP45 Modulating Booster Pump



## MBP45 Features

- Automatic multistage centrifugal pumping system
- Constant or modulating select feature
- Pressure select feature
- Utilises dry run protection feature
- High temperature warning feature
- Ergonomic and compact design
- Easy to install and operate
- Utilises an integrated flow switch
- Utilises an integrated pressure switch
- Utilises an integrated non-return valve
- User friendly integrated control panel
- Powerful & efficient variable speed motor
- 3 years manufacturers warranty
- High-performance air-cooled motor housing
- Adjustable constant pressure motor controller
- Robust component design and construction
- Suitable for domestic & light commercial applications
- Quiet operation, less than 45 DB at five metres distance
- Self Priming Feature—Up to 8 metres
- Anti-cease function—initiates the pump to run for 10 seconds should it not be called on to pump for a period of 24 hours or more
- Incorporates a "Loss of system pressure" indicator on the control panel

## Technical Data

- Motor Size: 0.8 HP / 600 Watt
- Motor Type: Variable Speed
- Rated Head: 25M
- Maximum Head: 45M
- Maximum Pressure: 4.5 Bar
- Maximum Flowrate / Q Max: 4.5M Cubed / 75L/Min
- Minimum and Maximum Fluid Temperatures: 5°C to 50°C
- Operating environment temperature 5 – 50 Degrees
- Motor water proof rating: IP44
- Maximum operating pressure 10 Bar
- Insulation class-F
- Pump weight: 14.2 Kg
- Inlet and Outlet connection sizing – 1" FI BSP/G1

| CODE   | PRODUCT | PALLET QTY | PRICE € |
|--------|---------|------------|---------|
| 771918 | MBP45   | 24         |         |

MBP-45 Pump Dimensions

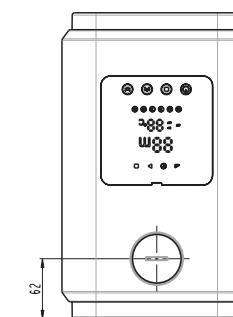
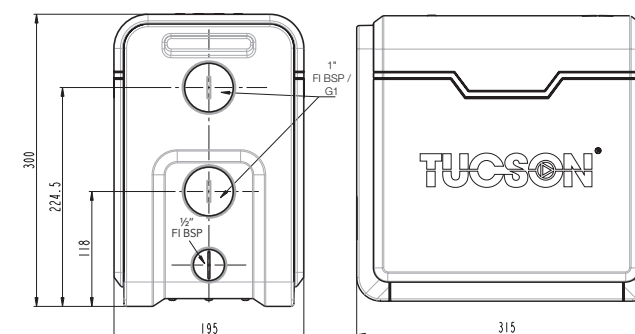

Dimensions in mm





# Tucson SBP90 Constant Speed Booster Pump

## SBP90 Features

- Compact design
- Powerful & efficient
- Easy to install and operate
- Utilises dry run protection
- Utilises an integrated flow switch
- Utilises an integrated pressure switch
- Utilises an integrated non-return valve
- Adjustable start-up pressure controller
- User friendly unintegrated control panel
- High-performance air-cooled motor housing
- Automatic multistage centrifugal pumping system
- Suitable for domestic & light commercial applications
- Robust construction with stainless steel bodied pump
- Quiet operation, less than 45 DB at five meters distance
- 3 years manufacturers warranty

## Technical Data

- Motor Size: ½ HP / 370 Watt
- Motor Type: Induction
- Rated Head: 33M
- Maximum Head: 37M
- Maximum Pressure: 3.7 Bar
- Maximum Flowrate / Q Max: 4 M Cubed / 66.6 L/Min
- Maximum Fluid Temperture: 50°C
- Operating environment temperature 5 – 50°C
- Motor water proof rating: IP55
- Controller water proof rating: IP65
- Controller Maximum operating pressure 10 Bar
- Insulation class-F
- Pump weight: 9.2 Kg
- Inlet and Outlet connection sizing: 1" FI BSP/G1 & 1" MI BSP/G1

| CODE   | PRODUCT | PALLET QTY | PRICE € |
|--------|---------|------------|---------|
| 771909 | SBP-90  | 28         |         |

## SBP-90 Pump Dimensions

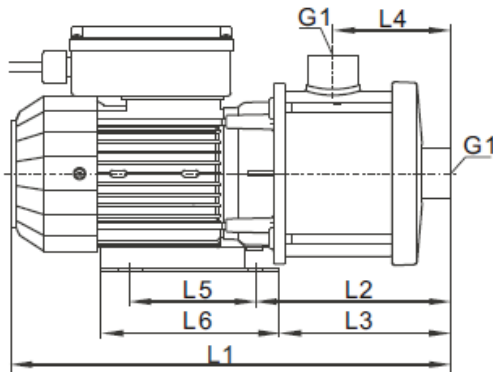
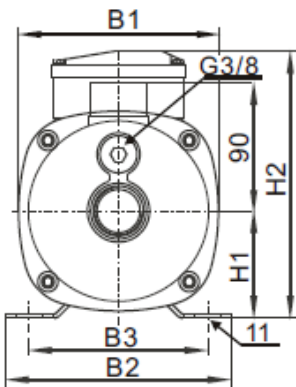

| B1  | B2  | B3  | H1 | H2  | L1  | L2  | L3  | L4 | L5 | L6  | G1        |
|-----|-----|-----|----|-----|-----|-----|-----|----|----|-----|-----------|
| 140 | 158 | 125 | 75 | 174 | 318 | 131 | 113 | 72 | 96 | 136 | 1" FI BSP |

Dimensions in mm

# Pressure Switches

## Pressure Switches

| CODE   | SIZE  | BOX QTY | PRICE € |
|--------|---|---------|---------|
| 771900 | MPS1 - Pressure Switch Manual                 | 50      |         |
| 771905 | MPS2LP - Loss of Prime Manual Pressure Switch | 50      |         |
| 771901 | APS1 - Automatic Pressure Switch 1            | 12      |         |
| 771907 | APS2 - Automatic Pressure Switch 2            | 12      |         |



APS1  
1" BSP / G1 Connections



MPS1

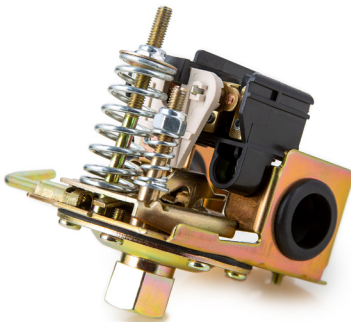

MPS2LP



APS2  
1" BSP / G1 Connections

## MPS2LP

A loss of prime pressure switch is essentially a "Dry-Run" protection devise for a well pump. Typically used where an independent well application uses a submersible or overground pump.

Where Installed this switch can identify Low Pressure in the supply pipework, should the pump pressure fall below 14 psi / 1 Bar, the loss of prime pressure switch will then initiate and isolate the power supply to the pump, thus protecting the pump from overheating.

3 YEAR WARRANTY

## Pump Accessories

### Tucson Flexible Connection Pump Hoses- WRAS Approved EPDM

Component Material:  
CW617N Brass, Stainless Steel Braided, EPDM Rubber

| CODE   | SIZE                           | HOSE LENGTH | BOX QTY | PRICE € |
|--------|--------------------------------|-------------|---------|---------|
| 771481 | 1" BSP MI x FI                 | 500mm       | 50      |         |
| 771482 | 1" BSP FI x FI                 | 500mm       | 50      |         |
| 771483 | 1" BSP MI x FI                 | 750mm       | 50      |         |
| 771484 | 1" BSP FI x FI                 | 750mm       | 50      |         |
| 771485 | 1" BSP FI x FI 90° Swept Elbow | 500mm       | 50      |         |
| 771486 | 1" BSP FI x FI 1M 90° Elbow    | 1000mm      | 50      |         |

All hoses are supplied with gasket washers

### Tucson Lever Action Pump Valves

Component Material:  
Chrome Plated CW617N Brass Valve with Carbon Steel Handle

| CODE   | SIZE               | BOX QTY | PRICE € |
|--------|--------------------|---------|---------|
| 771961 | 1½" BSP x ¾" CxC   | 50      |         |
| 771962 | 1½" BSP x 1" CxC   | 50      |         |
| 771963 | 1½" BSP x 22mm CxC | 50      |         |
| 771964 | ½" BSP x 28mm CxC  | 50      |         |
| 771965 | 1½" BSP x ¾" FI    | 50      |         |
| 771966 | 1½" BSP x 1" FI    | 50      |         |

All valves are supplied with gasket washers

### Tucson Equinox Flanges

| CODE   | SIZE                      | BOX QTY | PRICE € |
|--------|---------------------------|---------|---------|
| 759003 | 1" BSP Male x 22mm Spigot | 10      |         |
| 759006 | 1" BSP Male x 21mm Spigot | 10      |         |

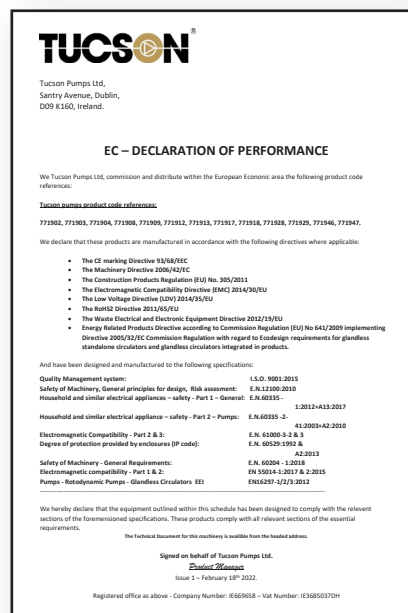
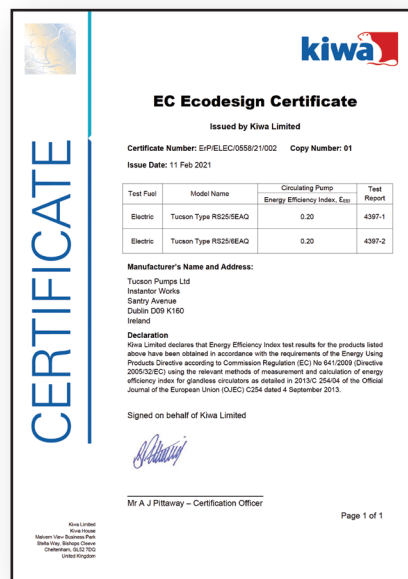

## Certifications





**Fluid Dynamics**

**Tucson Pumps Ltd.**  
Instantor Works  
Santry Avenue, Santry  
Dublin D09 K160

**T** 01 842 6255  
**E** [sales@tucsonpumps.ie](mailto:sales@tucsonpumps.ie)

**[www.tucsonpumps.ie](http://www.tucsonpumps.ie)**

Unpriced - Issue 3 - March 2022