

# New York Kitchen Tap



## COMPLIANCE APPROVALS

**BA Standards**  
BS EN200

**Wras Approved**  
Yes

**Guarantee**  
5 Year Guarantee

\*5 Year Guarantee on Taps and Showers applies to chrome finishes and main body of products.

\*All taps and showers must be cleaned with warm soapy water and soft cloths only. The use of abrasive cleaners or materials will render warranty invalid.

\*Flexible tail connections; thermostatic cartridges; hoses and handsets are covered by a 2 year guarantee.



## SPECIFICATION

Code	U39787
Style	Contemporary
Product Type	Kitchen Taps
Finish	Chrome
Main Construction Material	Brass
Inlet Connections	1/2"
Number of Tap Holes	1
Cartridge Type	1/2" CD Valve
Supply	Suitable for all Plumbing Systems
Working Pressure Range	0.3 - 5bar

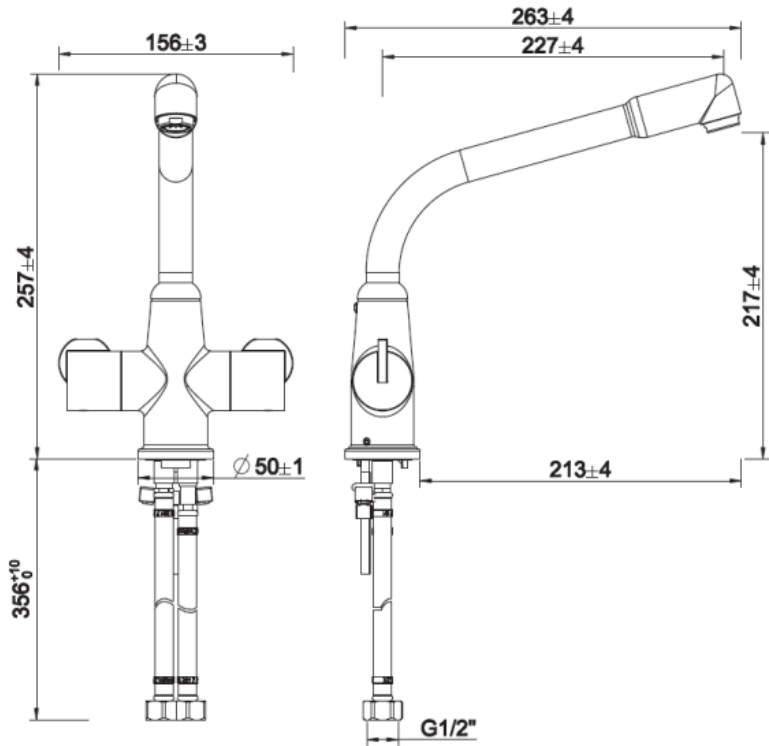

## Flow rate

Pressure (Bar)	Full hot water (L/Min)	Full cold water (L/Min)	Mixed water (L/Min) Main water outlet
0.1	2.3	2.6	4.5
0.3	6.1	6	11.5
0.5	8.4	8.2	15.7
1.0	12.2	12.1	23.1
3.0	21.7	21.6	40.9
5.0	28.2	28.2	53.3