

Heat Merchants

Product Code: U14830

HM PRO2 4-7m 130mm



Heating Circulating Pump

HM PRO2 4-7m 130mm

GENERAL DESCRIPTION

Our all new heating circulation pump designed and produced as an all round solution for domestic heating applications including replacement of old style fixed speed traditional pumps.

The HM PRO2 is fully compliant with the current ErP legislation for high efficiency products.

The HM PRO2 is one single model that replaces all current and historical domestic heating pumps in one solution. This is possible using our clever electronics and variable speed technology.

Dimensionally more compact than a traditional pump and features the a brass air bleeding plug, heavily requested by installers.

The HM PRO2 pump is the one perfect solution needed for domestic heating systems.

TECHNICAL FEATURES

The HM PRO2 technical features include:

- One model to replace all 4, 5 and 6 Metre head pumps
- Operational Settings:
3 fixed speed operation, 3 constant pressure or 3 variable speed options
- Simple one button selection and operation
- Compact design and dimensions
- Air venting brass plug to degass trapped air in the motor
- Quick coupling electrical cable connection plug
- High protection against water ingress IPX5 waterproofing rating
- High quality anti-corrosion material construction
- Increased energy saving motor design, EEI 0.18



Product Code: U14830

CONSTRUCTION CHARACTERISTICS

Cast iron pump body with special cathaphoresis anti-corrosion treatment and wet rotor motor. Motor casing in stainless steel 304. Technopolymer impeller. Stainless steel 304 rotor jacket, stator jacket and closing flange. EPDM seal rings and brass breather plug.

Thanks to the internal protection of the motor, the pump does not require any form of overload protection.

DIMENSIONS

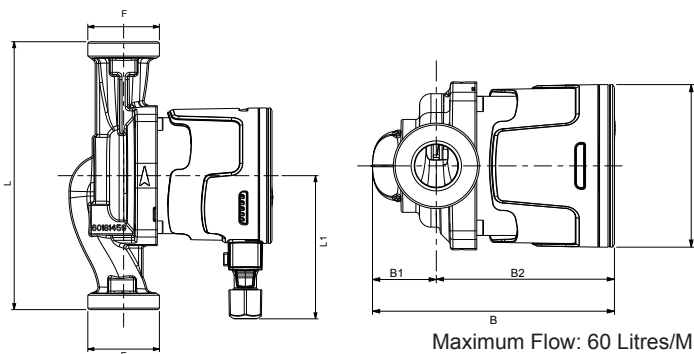

Maximum Flow: 60 Litres/Minute
Maximum working head: 6.7 Metres
Maximum closed valve head: 6.9 Metres

PERFORMANCE

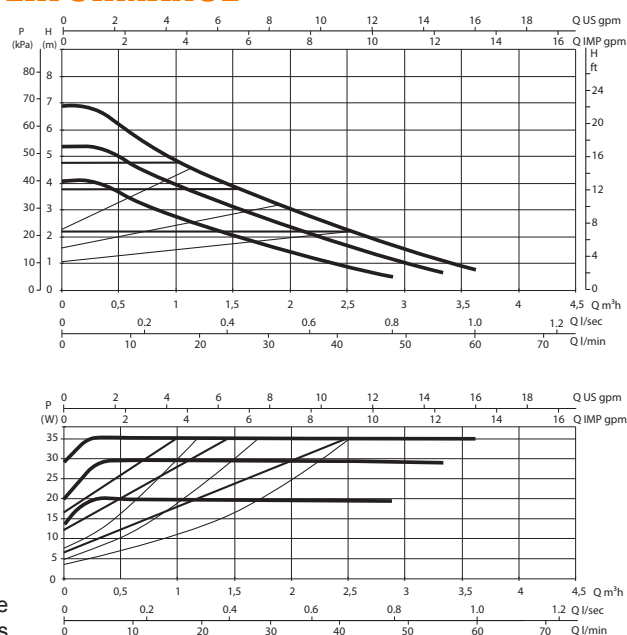

MODEL	L	L1	B	B1	B2	H	F	PACK DIMENSIONS			VOLUME m ³	WEIGHT Kg
								L	B	H		
HM PRO2 4-7m 130mm	130	96	135.5	26.4	109	91	1 1/2"	142	99	150	0.0021	2.02

MODEL	VOLTAGE 50 Hz	CENTRE DISTANCE mm	CONNECTIONS		ELECTRICAL DATA			MINIMUM SUCTION PRESSURE	
			PUMP BODY	UNION	P 1 Max W	In A		t°	m.c.a.
HM PRO2 4-7m 130mm	Single Phase 230 V	130	1 1/2" M BSP	1" F	MIN MAX	35	0,043 0,32	90°	10

Heat Merchants

Heat Merchants Group
Moydrum Road
Athlone
Co. Westmeath

COMPARISON GUIDE	GRUNDFOS	WILO	CIRCULATING PUMPS (CPL)	XYLEM LOWARA
HM PRO2 4-7 M 130mm	UPS 3 15-50/60	STRATOS PICO 25 1-6	CP 50	ECO CIRC 25-4 / 130
	UPS 2 15-50/60	YONOS PICO 25 1-4	CP 60	ECO CIRC 25-6 / 130
	ALPHA 2L 15/60	YONOS PICO 25 1-6		
	UPS 15/50	SMART A		
	UPS 15/60	SMART B		